

4

3

2

1

D

D

C

C

B

B

A

A

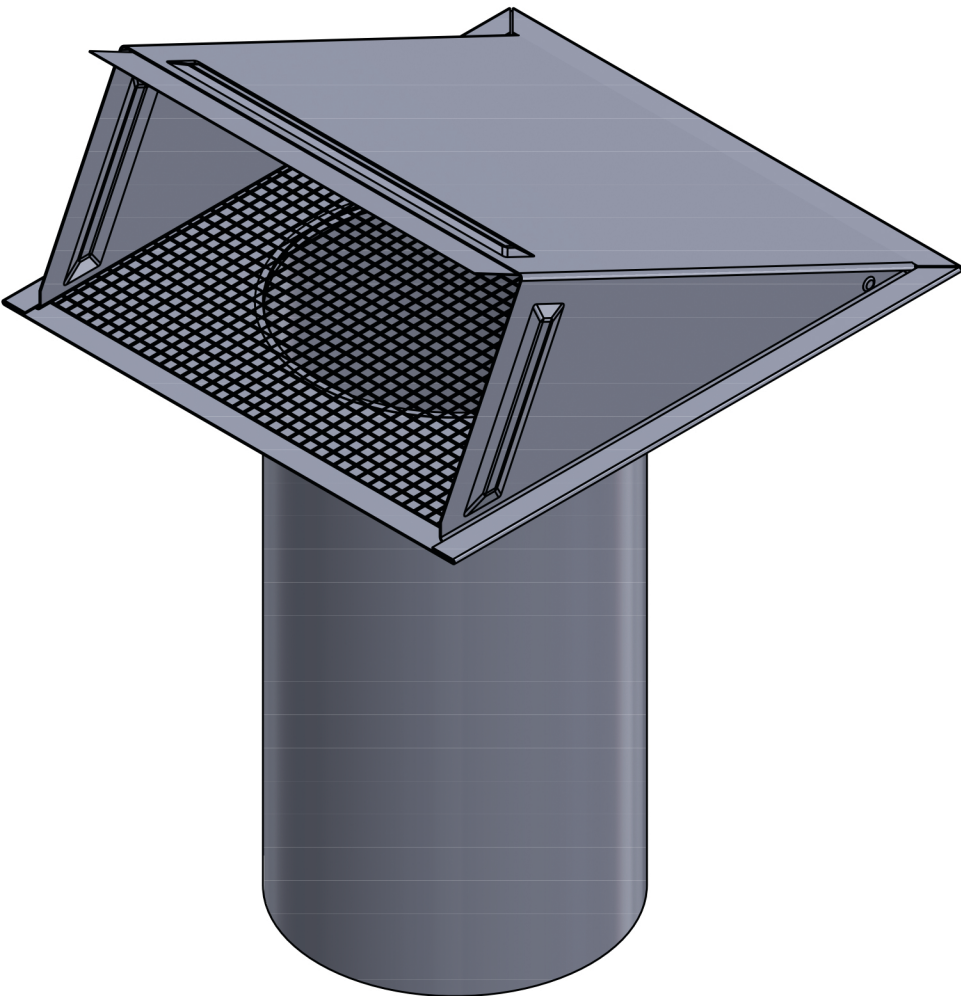
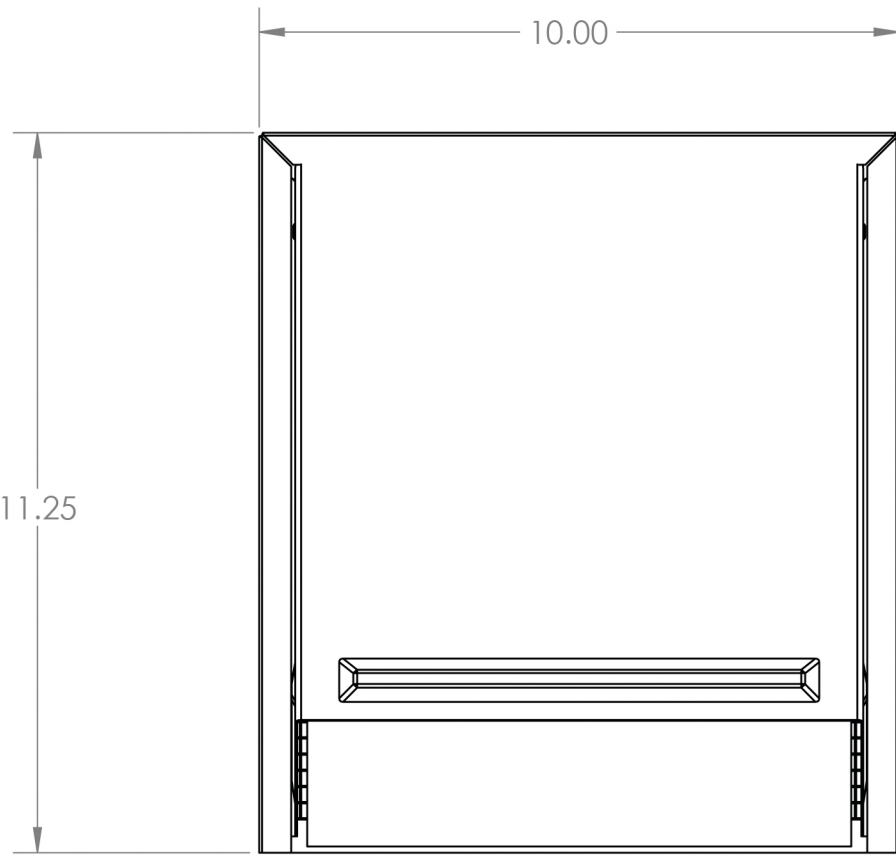

OPEN VENT

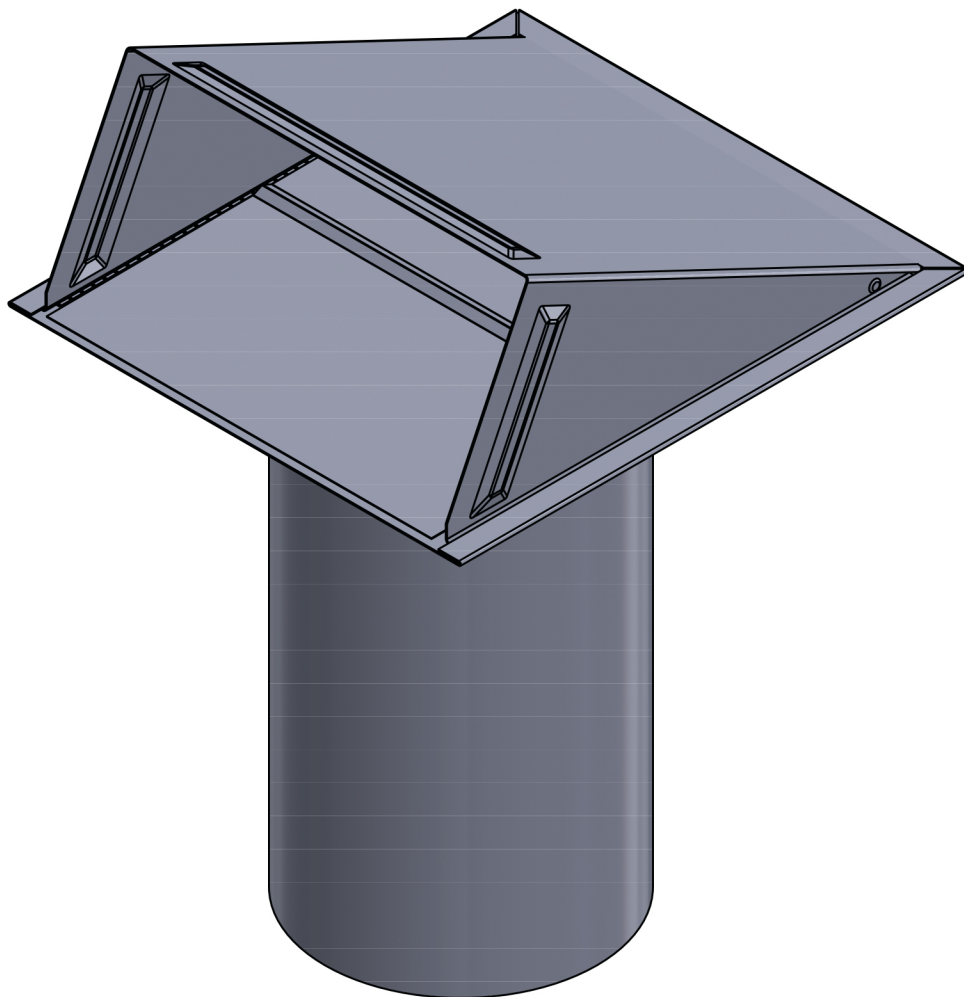
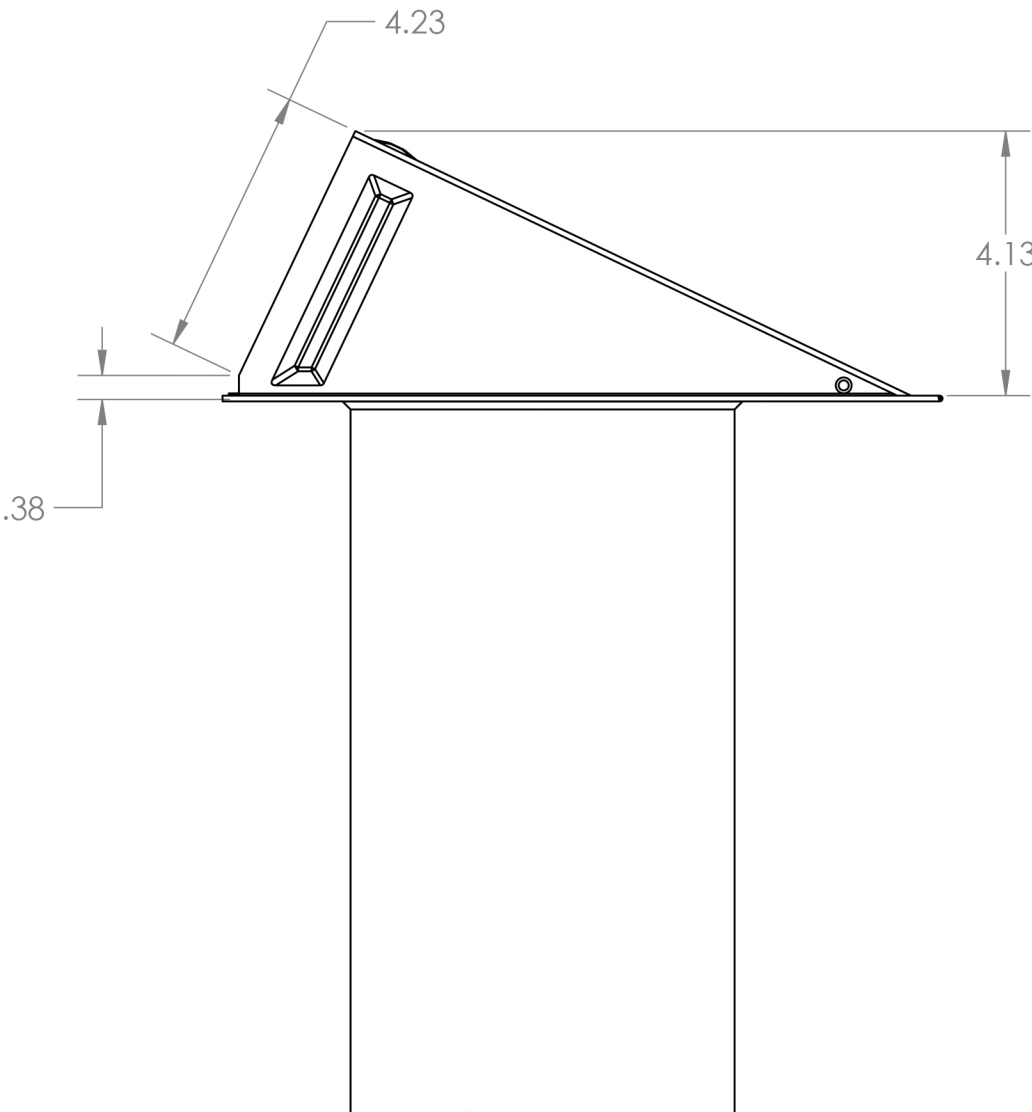
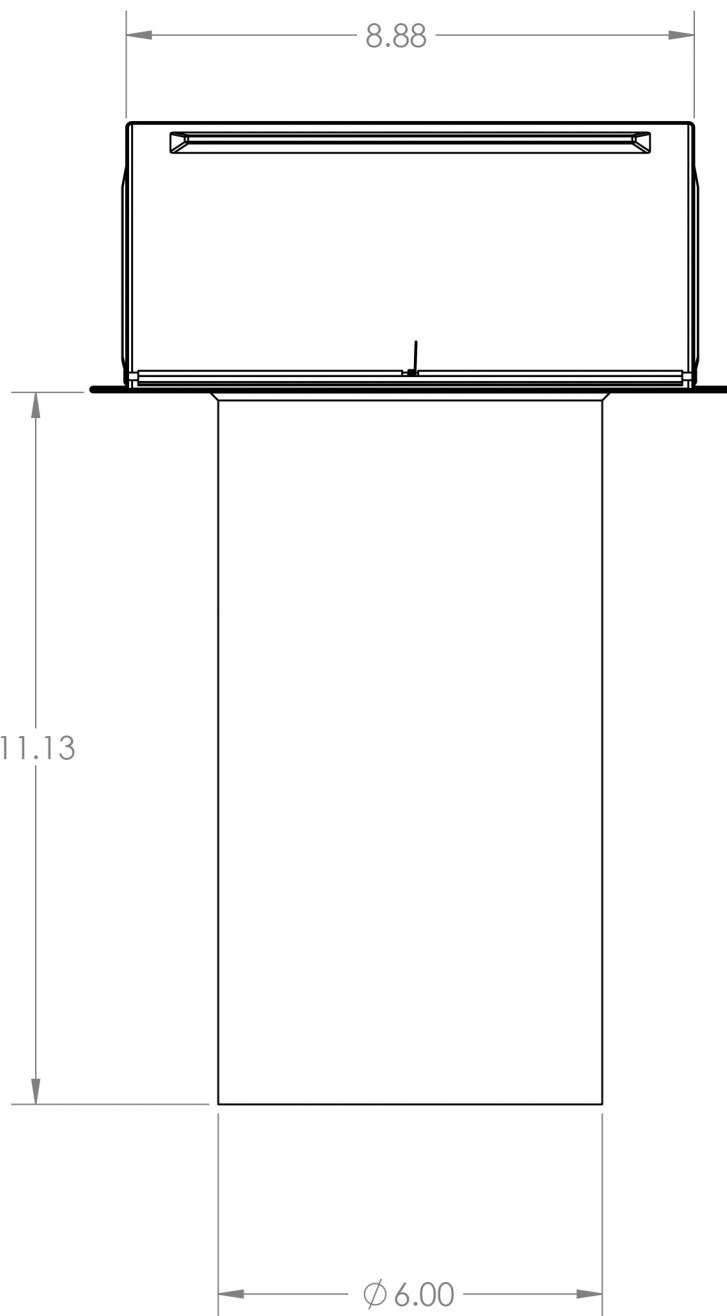

CLOSED

PROPRIETARY AND CONFIDENTIAL
THE INFORMATION CONTAINED IN THIS
DRAWING IS THE SOLE PROPERTY OF
LAMBRO. ANY REPRODUCTION IN PART
OR AS A WHOLE WITHOUT THE WRITTEN
PERMISSION OF LAMBRO IS PROHIBITED.

		UNLESS OTHERWISE SPECIFIED:		NAME	DATE
		DIMENSIONS ARE IN INCHES	DRAWN		
		TOLERANCES:	CHECKED		
		FRACTIONAL: 1/16	ENG APPR.		
		ANGULAR: MACH ± 1 BEND ± .01	MFG APPR.		
		TWO PLACE DECIMAL ± 0.01			
		THREE PLACE DECIMAL ± 0.005			
		INTERPRET GEOMETRIC TOLERANCING PER:	Q.A.		
		MATERIAL	COMMENTS:		
		FINISH	Net Free Area (NFA)		
NEXT ASSY	USED ON		Mouth Opening: 40 sq. in.		
			Opening With Screen: 15 sq. in.		
APPLICATION		DO NOT SCALE DRAWING	Spring Controlled Damper		

 Lambro Industries, Inc.
115 Albany Ave.
Amityville, NY 11701
(631) 842-8088
www.lambro.net

TITLE: 6" Galvanized Wall Exhaust Hood Vent
Spring Damper - 1/4" Wire Mesh Screen
11" Pipe
Cover, Base, Damper & Pipe: 26 Gauge

SIZE DWG. NO.
C 3460GMS-11
SCALE: 1:3 WEIGHT: SHEET 1 OF 1