

4X Ø .19 THRU ALL
□ Ø .38 ▽ .25

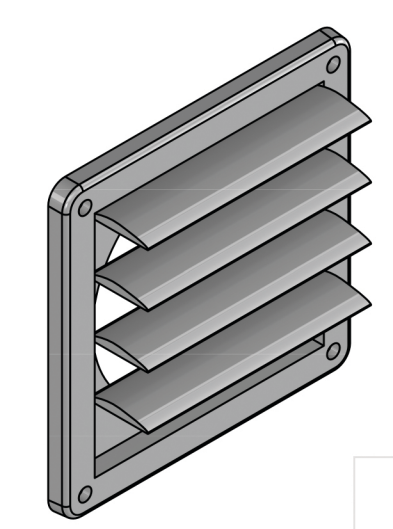



Lambro Industries, Inc.
115 Albany Ave.
Amityville, NY 11701
(631) 842-8088
www.lambro.net

PROPRIETARY AND CONFIDENTIAL
THE INFORMATION CONTAINED IN THIS
DRAWING IS THE SOLE PROPERTY OF
LAMBRO. ANY REPRODUCTION IN PART
OR AS A WHOLE WITHOUT THE WRITTEN
PERMISSION OF LAMBRO IS PROHIBITED.

		UNLESS OTHERWISE SPECIFIED:		NAME	DATE	TITLE: 6" Plastic Wall Exhaust Vent - Flush Mount (Louvered)				
		DIMENSIONS ARE IN INCHES TOLERANCES: FRACTIONAL ±1/16 ANGULAR: MACH ±1 BEND ±.01 TWO PLACE DECIMAL ±0.01 THREE PLACE DECIMAL ±0.005	DRAWN							
			CHECKED							
			ENG APPR.							
			MFG APPR.							
		INTERPRET GEOMETRIC TOLERANCING PER:	Q.A.							
		MATERIAL	COMMENTS: Net Free Area (NFA) 24 sq. in.			SIZE		DWG. NO.	REV	
		FINISH				B		361W-NC		
NEXT ASSY	USED ON									
APPLICATION		DO NOT SCALE DRAWING				SCALE: 1:4		WEIGHT:	SHEET 1 OF 1	

REV

SCALE: 1:4 WEIGHT: SHEET 1 OF 1